

Wizzdrum Instruction Manual

aug 2020

The assembly of a Wizzdrum kit is intuitive and fast. Take the following instructions into account for an efficient way to set up your kit.

Lay the case down flat on it's back

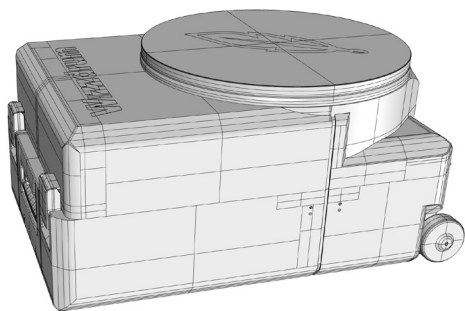

Remove the lid straight up and put it upside down

Take out the drums and place them next to the suitcase

Place pedals with cables and beater holder / hi-hat holder next to the case

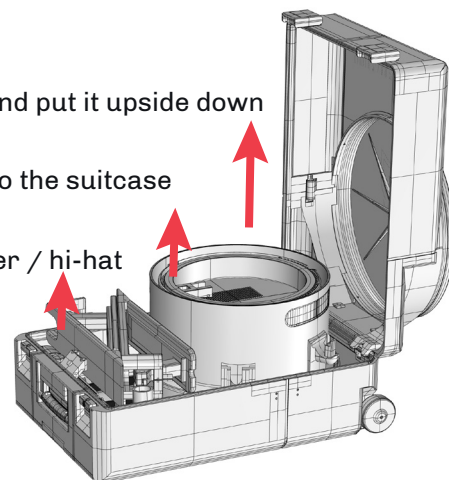

Order of construction:

- Lift security pen and take out knot (1). Set it to height (*) and put it aside
- Backbone (2)
- Attach legs (3) with ends facing the playing side
- Vertical (4) (playing standing up)
- Mount the knot (1) with the mouth facing the audience
- Mount horizontal (5) (note shape protrusion in knot and hole in horizontal)

Cymbal supports must be mutually shifted in the case, otherwise the bass drum will be lifted too high and the lid cannot close

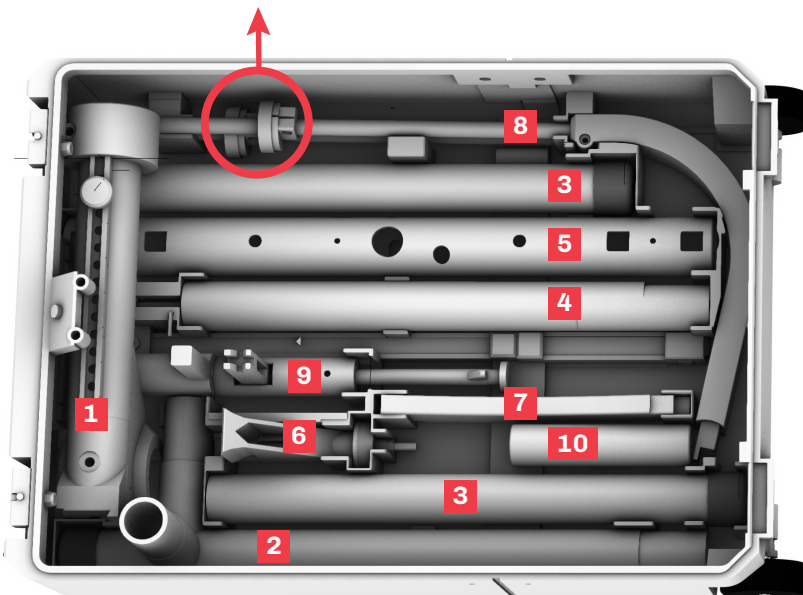

- Insert hi-hat holder (6) (with or without a pedal) at an angle and secure with toggle. The back of the hi-hat and knot must be aligned, behind ridge on knot
- Tom stands (7) in outer holes of horizontal, pointing to playing side
- Slide the cymbal stands (8) into holes on the front and lock with a screw.

(*) For playing standing up, place the memory lock at the number corresponding to your height (eg, 8 corresponds to 1.8 meter). Place the lock towards the top when playing seated and find your preferred setting.

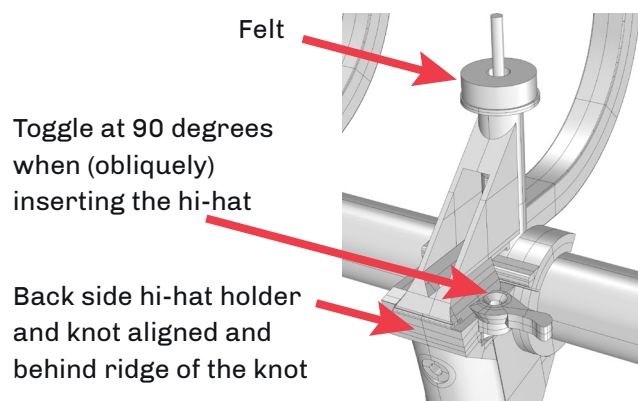
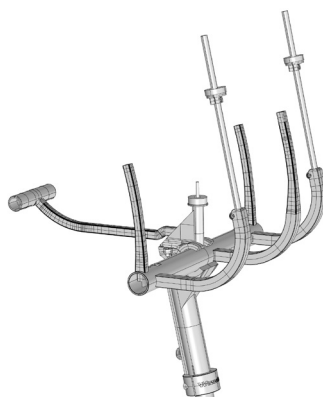
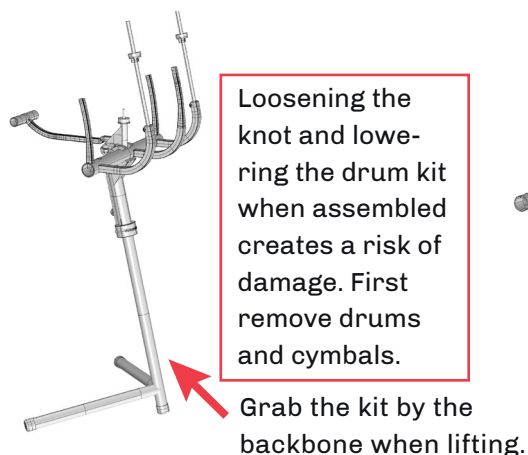

The drums can be placed onto the tom holders in various ways. This manual is based on a right handed player. Mirror the drums if you're a left handed player. If you're playing in a standing position mount the hi-hat manual lever (10 + 11), otherwise leave it in the case. Mount the middle tom holder (12), secured in the lid of the carrying case. Then mount the snare drum (9) and the hi-hat cymbals (13). The 10" mid-tom thereafter, which can be placed by using the hole adjacent to the edge of the drum (hereby positioning it above the hi-hat). The 8" tom on the left side and the 10" tom on the right side. Finally, mount the bass drum.

Toggles for hi-hat lever (11) and midtom stand (12)

Unscrew the cymbal package (13) from the lid

Playing nut (14) for hi-hat. Exchange this with knurled nut (15), which holds the cymbal package.

Protrusion for hi-hat lever

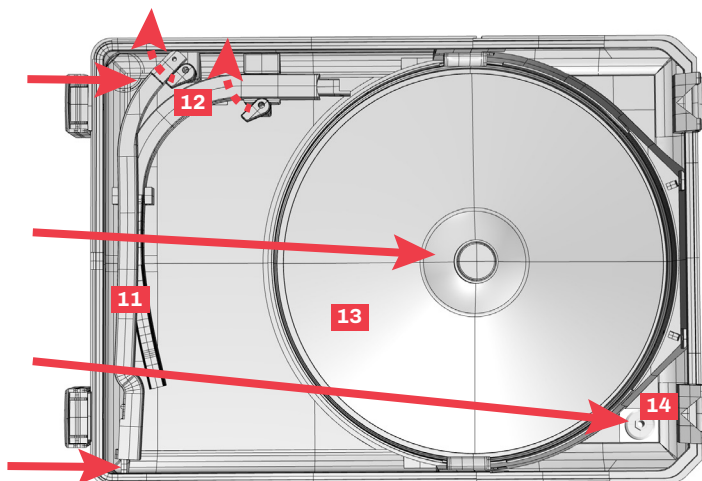

Situation when playing

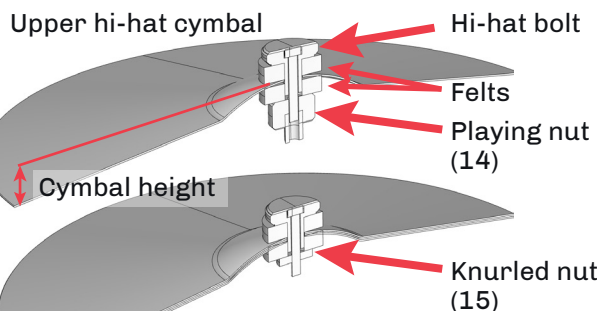

Situation when storing in the lid

Due to the difference in cymbal heights, the correct felts must be selected. The following combination fits with a cymbal height of 34 mm:

Top felt of 20 mm high
Bottom felt of 10 mm high
If necessary, exchange with felts on cymbal stands.

1. Bass drum,
 2. 10" Tom,
 3. 8" Tom upside down,
 4. 10" Tom upside down,
 5. 10" Snare upside down.
- Felted in-between with tuning holes of the drums at the location of felt flaps to prevent damage.

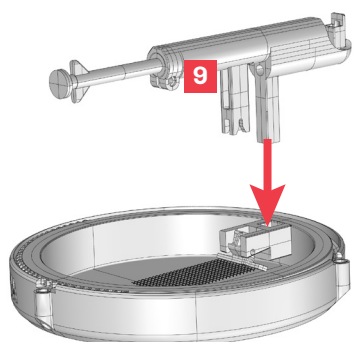
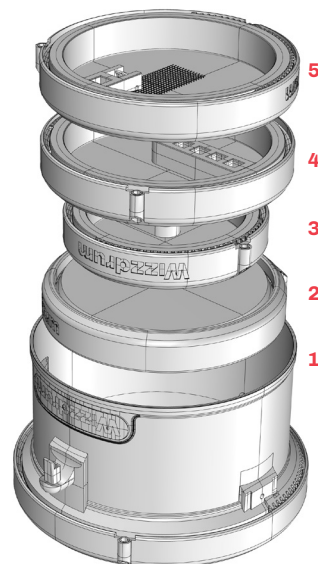

Flip snare drum upside down when mounting the snare mechanism for the right connection of the snare wire mat.

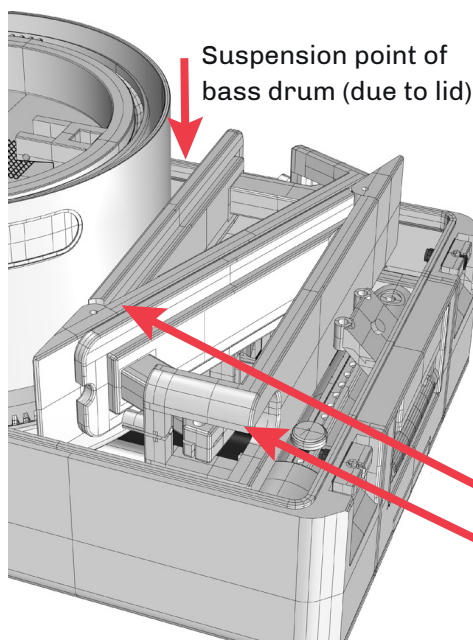

Placing pedals in case:

1. Pedal for bass drum first. Beater housing (without beater) right below the pedal. Hide the cable so that the case can close properly.
2. Insert hi-hat pedal and lay cable with hi-hat holder around drum. Insert the holder under or inside the pedal.

Pedal with hi-hat holder

Pedal with beater housing

Important instructions:

1. The upper part of the carrying case must close easily without forcing it. If the carrying case doesn't close something is not correctly placed in the case.
2. The most ideal position for the bass drum pedal on the ground is in the triangle of the stand.
3. The anti-slip mats should be used underneath the pedals to ensure a proper working of the pedals.
4. The drawbar of the carrying case is not suited for lifting the carrying case. Use the handle for this.
5. During tuning, beware that you take into account the maximum tension the tuning system can handle. When you feel that turning the tuning key is getting very difficult, you should acknowledge that you have reached the highest possible pitch. Trying to increase the tension past this point can result in damage to the teeth of the inner rim of the drum or the tuning key.
6. As indicated on the website, the printing material PLA has a softening temperature of 60 - 70° celcius. Do not expose the material to prolonged sunlight, especially behind glass in the car.